

# CNC machine

with servo motor drive

**FLATCom**<sup>®</sup>  
XL series



## Features

- Windows-based software
- Gantry drive
- Mobile portal, fixed bench

FlatCom XL with control pult iOP-19

## Technical specifications

	FLATCom <sup>®</sup> 102/72	FLATCom <sup>®</sup> 102/112	FLATCom <sup>®</sup> 142/112	FLATCom <sup>®</sup> 142/162	FLATCom <sup>®</sup> 142/252
Processing areas X/Y [mm] *	1,020 / 720	1,020 / 1,120	1,420 / 1,120	1,420 / 1,620	1,420 / 2,520
Z lift [mm]	210 (optional: 410, in each case without processing unit)				
Bench clamping area W x D [mm]	1,125 x 1,300	1,125 x 1,700	1,500 x 1,700	1,500 x 2,200	1,500 x 3,050
Z gap [mm] *	235 (optional 435, in each case without processing unit)				
Dimensions WxDxH [mm]	2,084/1,584/1,990	2,084/1,984/1,990	2,459/1,984/1,990	2,459/2,484/1,990	2,459/3,384/1,990
Processing speed X/Y/Z	max. 250				
Repeat accuracy [mm]	± 0.02				
Drive motors	Servo motors				
Drive elements X/Y/Z	Recirculating ball drive, adjustable for no play				
Controller	iMD CAN controller with 4 drive controllers, expandable to 12 axes (max. 6 interpolated & 6 handling axes), PC, I/O module, safety circuit with rest state monitoring, power supply unit 48V/1000 W				
Operation	Control pult iOP-19-CPU				
Weight [kg]	approx. 550	approx. 600	approx. 700	approx. 800	approx. 1000
Software	Windows, WinRemote (optional: ProNC, isy 2.8)				
Connection values	400 V, 16 A				
Part-no. (Z lift = 210 mm)	276552 0013E	276553 0013E	276554 0013E	276555 0013E	276556 0013E

\* without mounted components on the axes !

# CNC machine

## with servo motor drive

# FLATCom<sup>®</sup>

## XL series

### Features

- Portal gap: 235mm optional 435mm (for bigger workpieces)
- Maintenance-free servo motors
- Particularly suitable for the whopping editing (aluminium, non-ferrous metals, ceramics etc...)
- Installation of spindle motors up to 3.6 KW, SK 30 tool holders
- Available with or without protective hood
- Ideal for multi-shift operation
- Control pult iOP-19-CPU
- Control PC iPC 25 including PCI card Win 7/64 bit

### Areas of applications

For the machining of:

- Light metals
- non-ferrous metals (brass, bronze etc...)
- CFRP
- Ceramic
- Plastics
- Wood

### Options

- PC control console with free PCI plug-ins (for use by external PCI hardware)
- Safety light curtain
- Milling and engraving spindles
- SK11/SK20 automatic tool change stations
- Minimum quantity lubrication or CoolMin cooling system
- Vacuum clamping benches
- Suction device
- 4th axis e. g. RDH series installation
- Version without hood
- Maximum 6 interpolated axes + 6 handling axes
- Portal gap 435 mm

### Dimensioned drawings

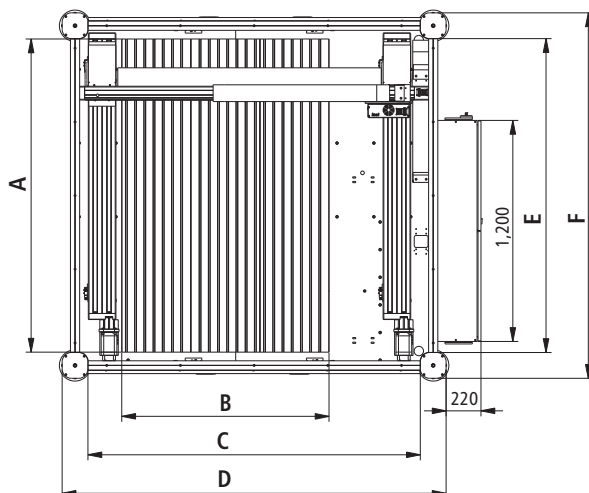
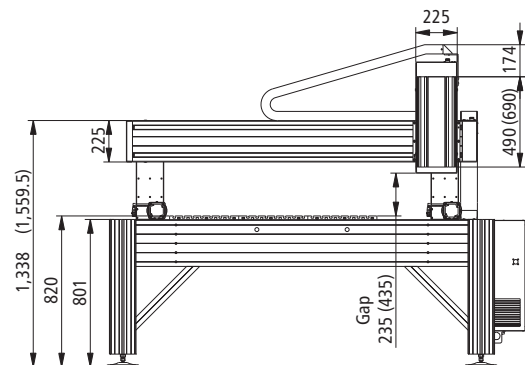
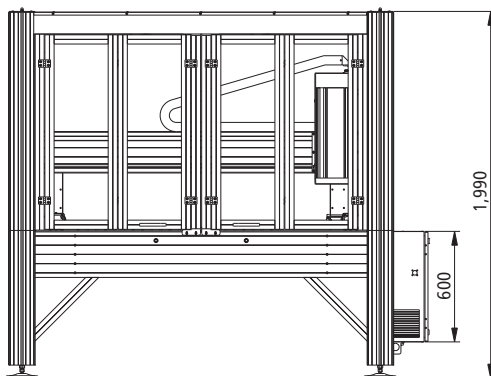

	A	B	C	D	E	F
FlatCom XL 102/72	1,300	1,125	1,804	2,084	1,304	1,584
FlatCom XL 102/112	1,700	1,125	1,804	2,084	1,704	1,984
FlatCom XL 142/112	1,700	1,500	2,179	2,459	1,704	1,984
FlatCom XL 142/162	2,200	1,500	2,179	2,459	2,204	2,484
FlatCom XL 142/252	3,050	1,500	2,179	2,459	3,100	3,380

Technical specifications subject to change.