

LATHE

# FAST, EASY, AND PRECISE TURNING

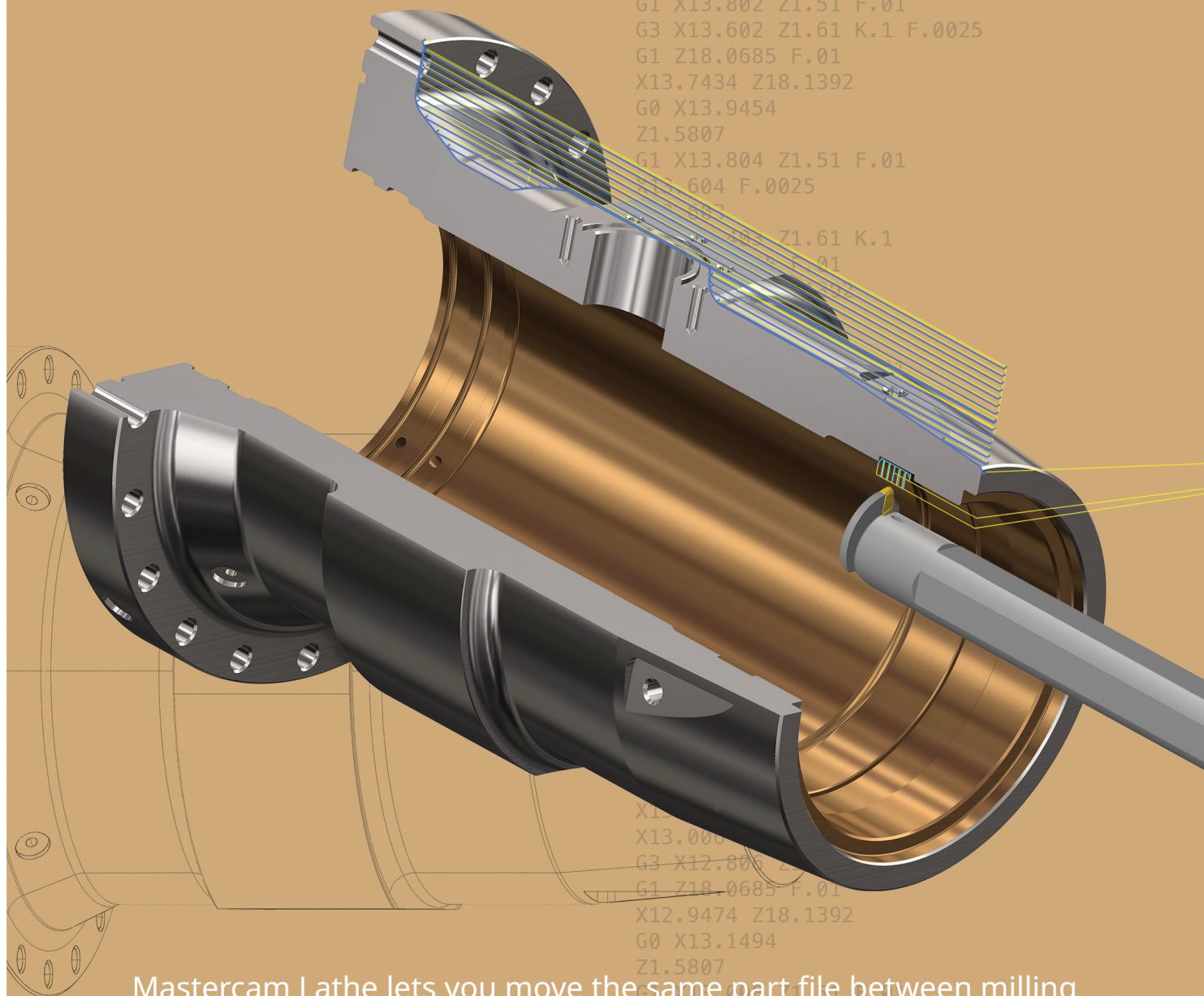

Mastercam Lathe lets you move the same part file between milling  
and turning operations with ease and confidence.

**Mastercam**

POWERED BY MASTERCAM'S  
DYNAMIC MOTION™ TECHNOLOGY





# POWERFUL, FLEXIBLE TOOLS FROM THE MARKET LEADER

## A set of tools that streamlines your entire process.

From importing any CAD file to Dynamic roughing and precision finishing, Mastercam Lathe gives you a variety of strategies to turn parts with greater efficiency and productivity.

## Efficient programming, designed for modern manufacturing.

Mastercam Lathe delivers a set of easy-to-use, advanced programming tools with greatly expanded options when paired with Mastercam Mill. Easy rough, finish, thread, groove, bore, and drill routines combine with C/Y-axis machining to cut any job. Dependable toolpath verification ensures your parts are done right the first time.

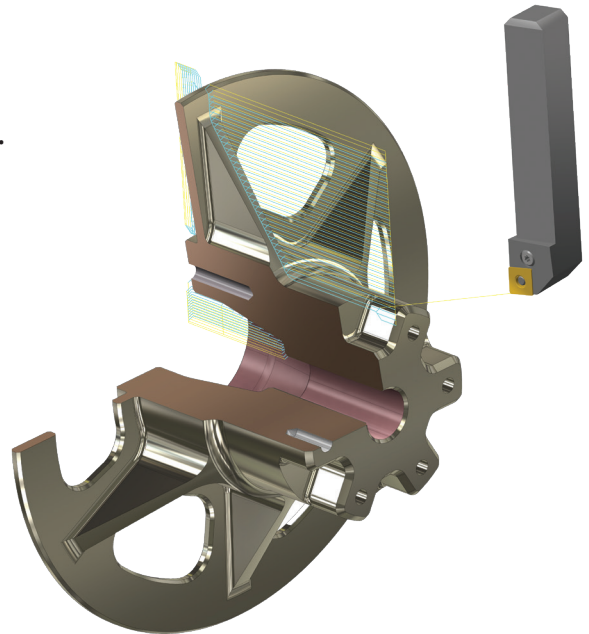

Select lathes offer expanded job setup, part transfer, and programming options.

## TIME AND MONEY

### 100 Hastelloy parts cut with and without Dynamic toolpaths.

<u>With</u>	<u>Without</u>
40 mins.	5 hrs.
1.5 inserts per part	12.5 inserts per part
\$100/hour machine cost	\$100/hour machine cost
40 mins. x \$100/hr. = \$66	5 hrs. x \$100/hr. = \$500
1.5 inserts @ \$25 = \$37.50	12.5 inserts @ \$25 = \$312.50
\$103.50 per part x 100 parts = <b>\$10,350</b>	\$812.50 per part x 100 parts = <b>\$81,250</b>

**Real world savings of 87%**

## Key turning features.

- **Quick Toolpaths** let you program in a few clicks.
- Intelligent ID and OD roughing.
- **Dynamic Motion** roughing extends insert life.
- Rough parts in sections or over the entire model.
- Fast facing including roughing and finishing.
- Grooving with multiple depth cuts, including peck motion and full-radius plunge turning.
- Complete and easy threading.
- Control chip breakage on difficult-to-machine materials.
- **Automatic gouge checking** on the tool's front and back.
- Chuck, part, steady rest, and tailstock detection.
- Easily machine wireframe, surface, and solid models.
- Create turning profiles on any shaped part.
- **Full milling support available** for machines with live tooling for C and Y axes.
- **Expanded job setup, part transfer and programming** options on select lathes.



With your standalone license of **Mastercam Mill**, you now have the option of also running the corresponding version of **Mastercam for SOLIDWORKS®**.

Contact a local Mastercam expert at  
[Mastercam.com/Resellers](http://Mastercam.com/Resellers)